

Chief Justice Milvain B AM

Operator: Southland - Ogden Yard (403) 253-9323
Description: Coral Springs

Eff: 2019-09-03

#	Time	Description
1	8:48 AM	Westbound Coral Springs Blvd after Coral Sands Terrace NE at the CT Stop
2	9:00 AM	Chief Justice Milvain School, Northbound 42 Street NE

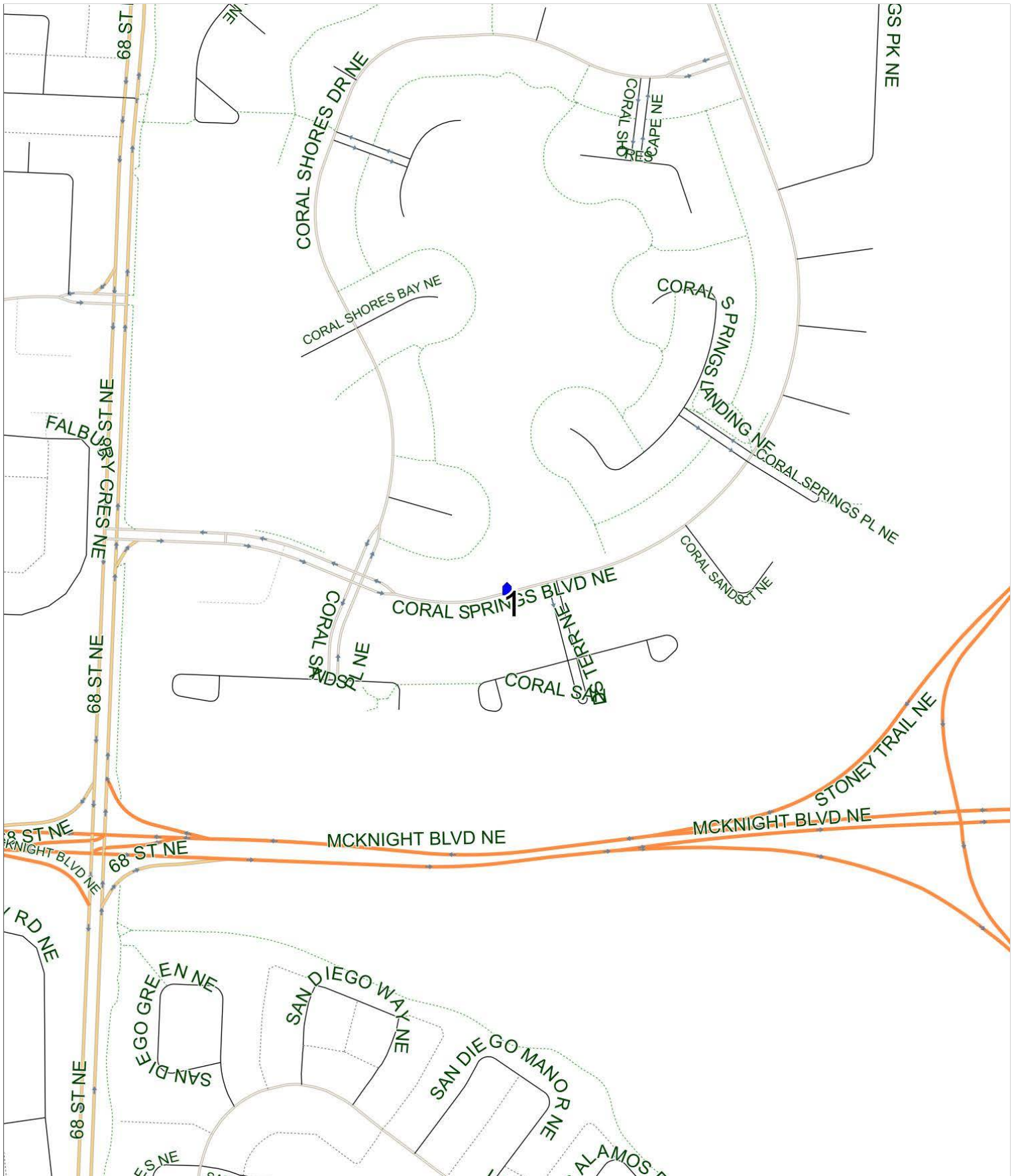

Chief Justice Milvain B PM (MTWR)

Operator: Southland - Ogden Yard (403) 253-9323
Description: Coral Springs

Eff: 2019-09-03

#	Time	Description
1	4:00 PM	Chief Justice Milvain School, Northbound 42 Street NE
2	4:14 PM	Westbound Coral Springs Blvd after Coral Sands Terrace NE at the CT Stop

Chief Justice Milvain B PM (F)

Operator: Southland - Ogden Yard (403) 253-9323
Description: Coral Springs

Eff: 2019-09-03

#	Time	Description
1	1:10 PM	Chief Justice Milvain School, Northbound 42 Street NE
2	1:22 PM	Westbound Coral Springs Blvd after Coral Sands Terrace NE at the CT Stop

