

Ian Bazalgette/Valley View B AM

Operator: Southland - Ogden Yard (403) 253-9323
 Description: Temple, Rundle, Marlborough

Eff: 2019-08-15

#	Time	Description
1	7:17 AM	Northbound 55 Street after Templewood Drive NE after the pathway
2	7:27 AM	Eastbound Rundlehorn Drive after 61 Street NE at CT Stop
3	7:34 AM	Southbound Madigan Drive after Malvern Drive NE (north arm) after CT Stop
4	7:45 AM	Ian Bazalgette School, Eastbound 26 Avenue SE
5	7:50 AM	Valley View School, Eastbound 26 Avenue SE

Ian Bazalgette/V alley View B PM (MTWR)

Operator: Southland - Ogden Yard (403) 253-9323
 Description: Temple, Rundle, Marlborough

Eff: 2019-08-15

#	Time	Description
1	2:45 PM	Valley View School, Eastbound 26 Avenue SE
2	2:55 PM	Northbound Madigan Drive after Malvern Drive NE (north arm) at CT Stop
3	3:05 PM	Eastbound Rundlehorn Drive after 61 Street NE at CT Stop
4	3:13 PM	Northbound 55 Street after Templewood Drive NE after the pathway

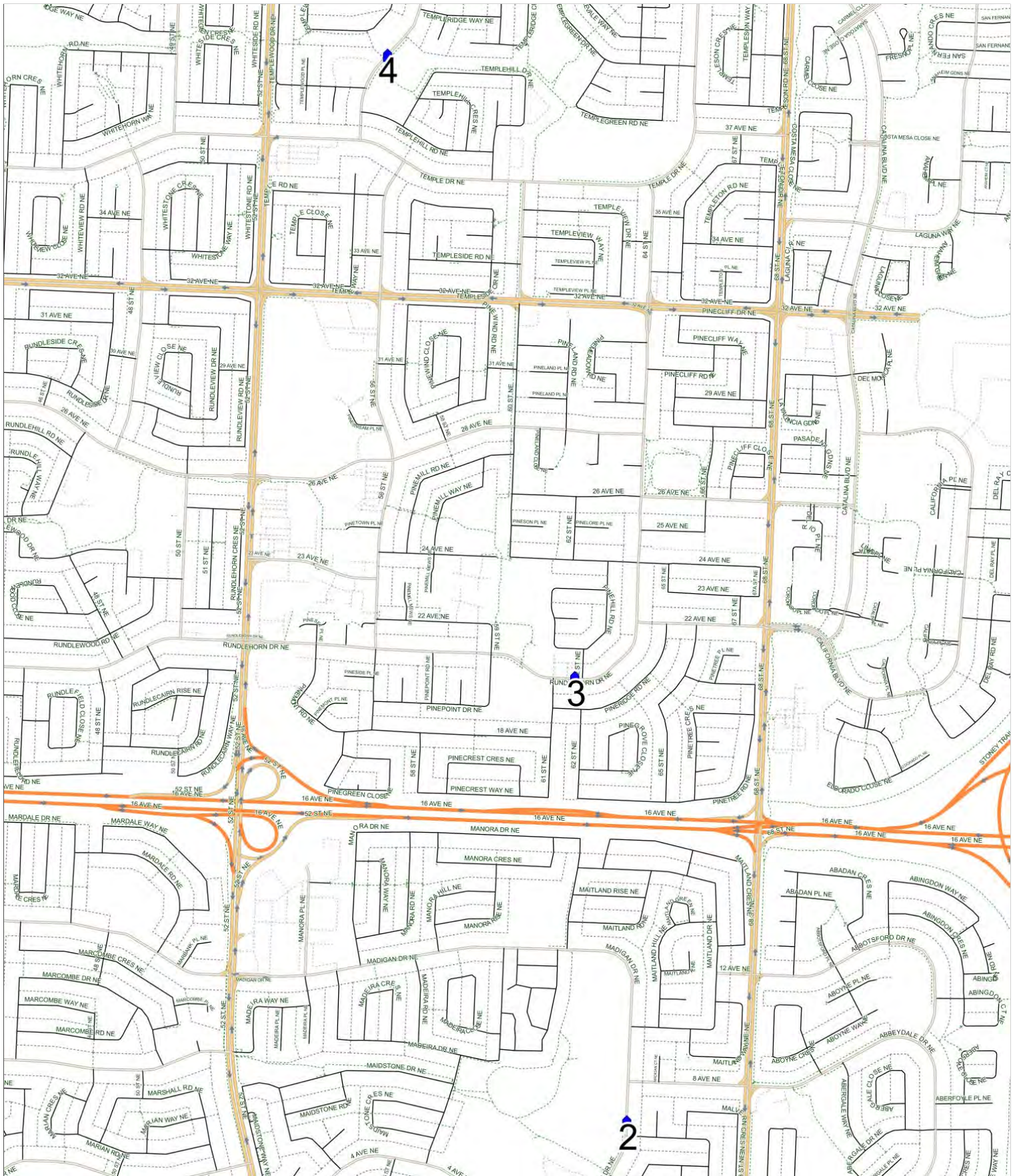

Ian Bazalgette/V alley View B PM (F)

Operator: Southland - Ogden Yard (403) 253-9323
 Description: Temple, Rundle, Marlborough

Eff: 2019-08-15

#	Time	Description
1	12:25 PM	Valley View School, Eastbound 26 Avenue SE
2	12:35 PM	Northbound Madigan Drive after Malvern Drive NE (north arm) at CT Stop
3	12:45 PM	Eastbound Rundlehorn Drive after 61 Street NE at CT Stop
4	12:53 PM	Northbound 55 Street after Templewood Drive NE after the pathway

