

# Nickle D

Operator: Southland - Ogden Yard (403) 253-9323  
Description: Auburn Bay

Eff: 2019-09-03

| # | Time    | Description  |
|---|---------|--|
| 1 | 8:45 AM | Eastbound Auburn Bay Blvd (north arm) after Autumn Crescent SE (west arm) at green space |
| 2 | 9:05 AM | Nickle School, Northbound Bonaventure Drive SE   |

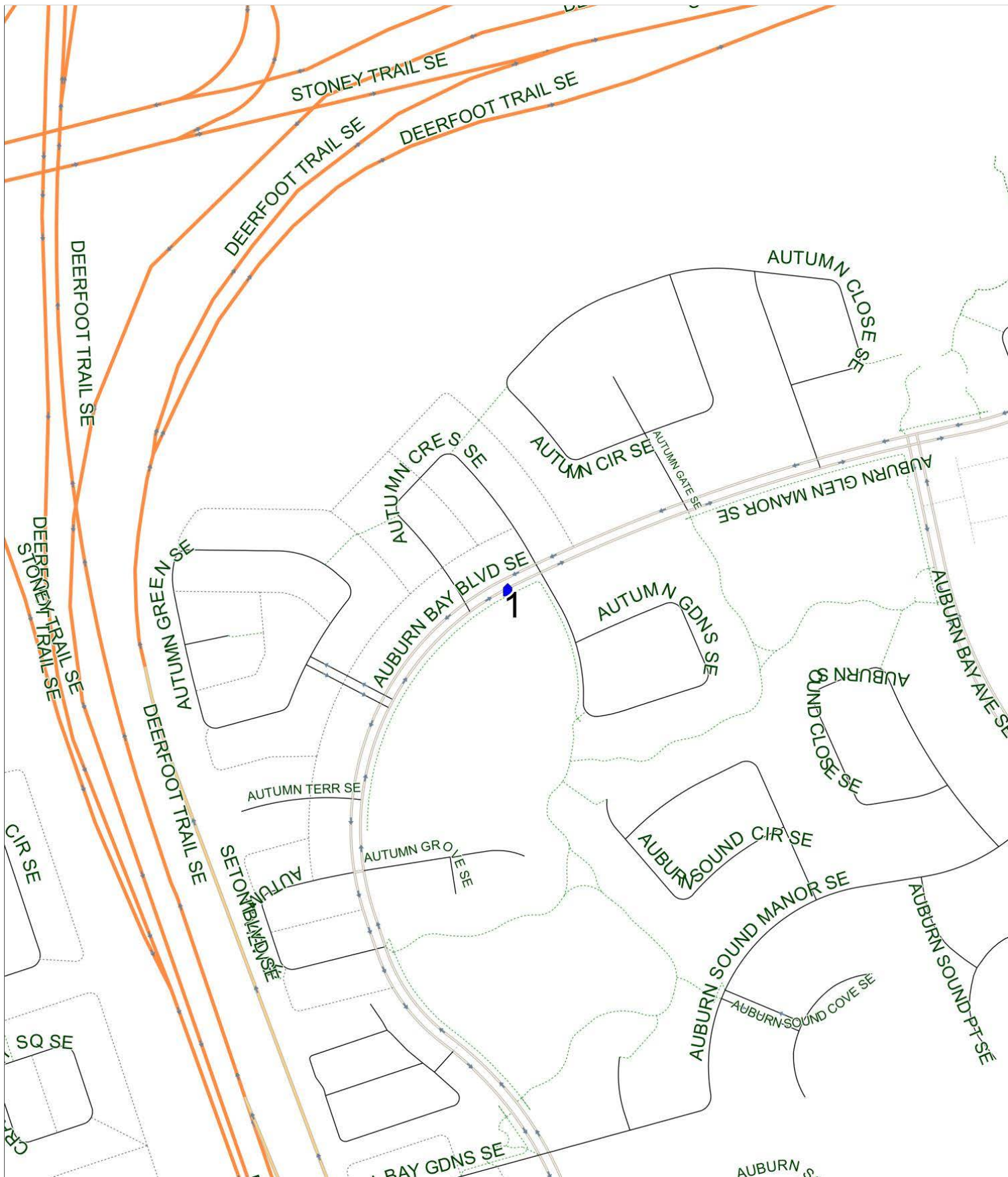

### Nickle D PM (MTWR)

Operator: Southland - Ogden Yard (403) 253-9323  
Description: Auburn Bay

Eff: 2019-09-03

| # | Time    | Description  |
|---|---------|--|
| 1 | 4:05 PM | Nickle School, Northbound Bonaventure Drive SE   |
| 2 | 4:23 PM | Eastbound Auburn Bay Blvd (north arm) after Autumn Crescent SE (west arm) at green space |

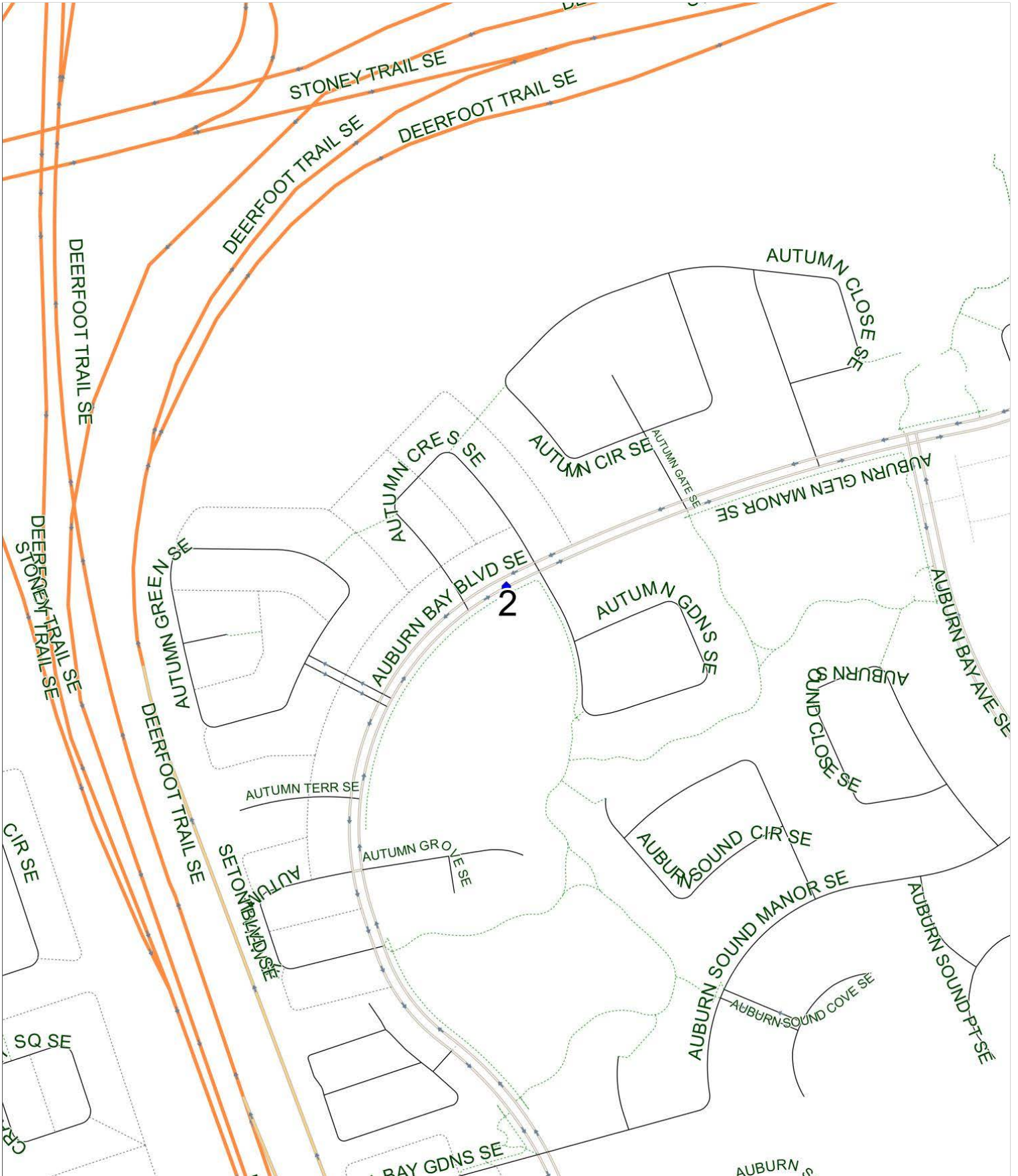

### Nickle D PM (F)

Operator: Southland - Ogden Yard (403) 253-9323  
Description: Auburn Bay

Eff: 2019-09-03

| # | Time    | Description  |
|---|---------|--|
| 1 | 1:20 PM | Nickle School, Northbound Bonaventure Drive SE   |
| 2 | 1:39 PM | Eastbound Auburn Bay Blvd (north arm) after Autumn Crescent SE (west arm) at green space |

